

### LICZNIKI ENERGII

Liczniki mechaniczne **DME M100...**  
 Liczniki cyfrowe **DME D100... - DME D110...**

Liczniki cyfrowe **DME D115 T1 - DME D120 T1...**  
**DME D121 - DME D130**

Liczniki cyfrowe **DME D300 T2... - DME D300 F -**  
**DME D310 F... - DME D310 T2... - DME D320**  
 Rejestrator danych **DME CD - DME CD PV1...**

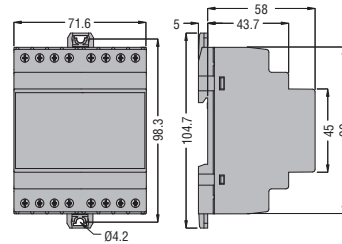
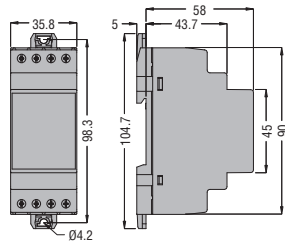
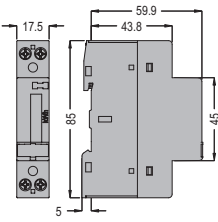

### MULTIMETRY

**DMG 200 - DMG 210 - DMG 300**

Moduły rozszerzeń **EXM...**

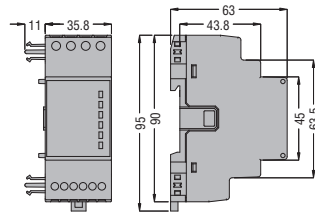
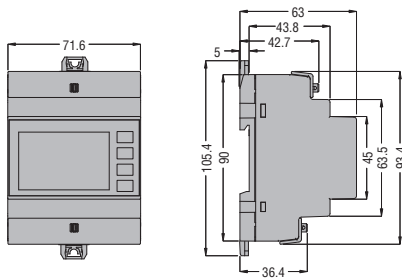

### DMG 600 - DMG 610

**DMG 700 - DMG 800... - DMG 900... z modułami serii EXP...**

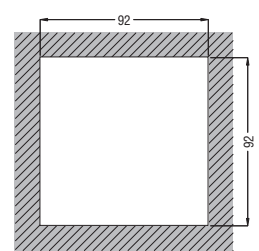
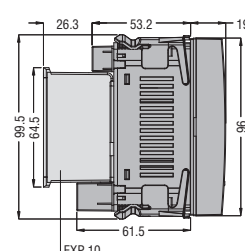
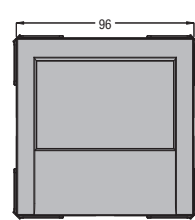
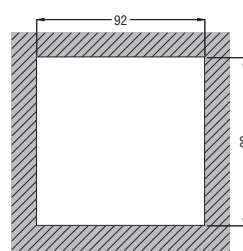
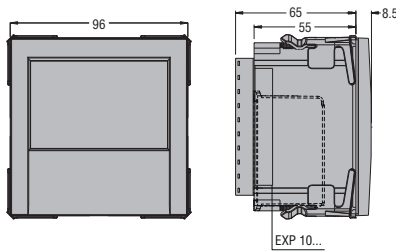

Przetwornik pomiarów **DMG 900T z modułami serii EXP...**

Zdalny wyświetlacz **DMG 900RD**

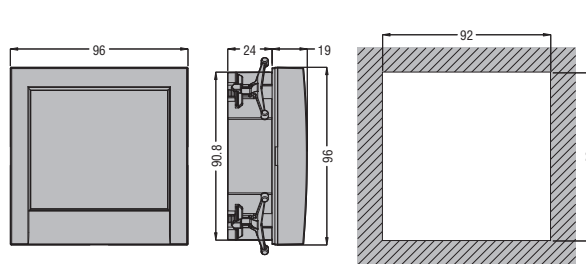
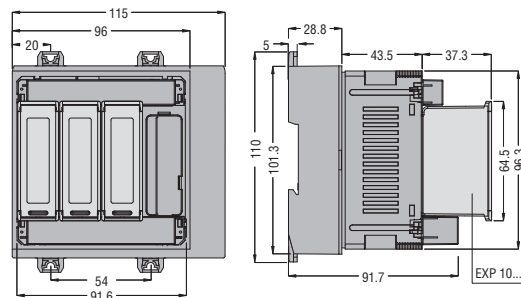

### URZĄDZENIA POMIAROWE

Urządzenia **DMK 0... - DMK 1...**

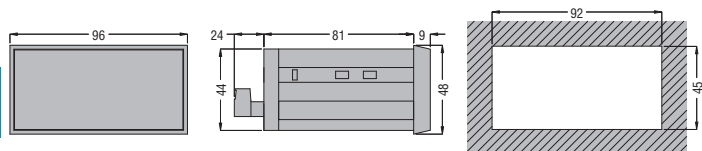

### MIERNIKI

**DMK 2...**

**DMK 3... - DMK 40**

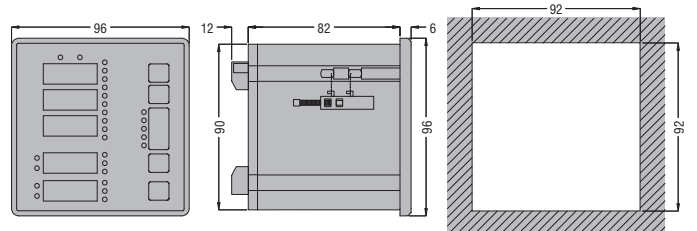
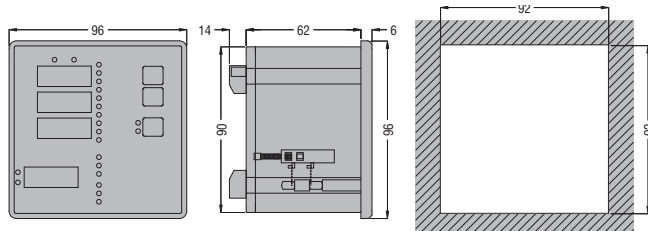

### URZĄDZENIA DMK 7... - DMK 8...

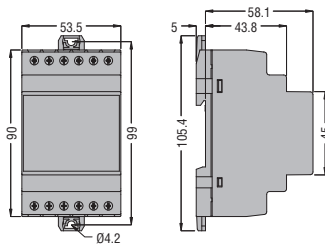

### Mierniki DMK 5... - DMK 6...

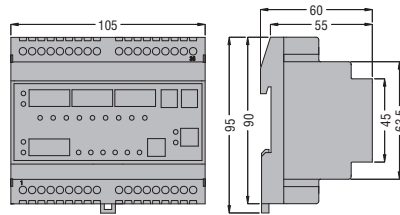

### PRZEKŁADNIKI PRĄDOWE

#### Rdzeń nieotwierany DMOT...

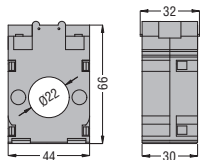

#### DM2T...

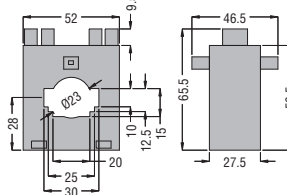

#### DM3T...

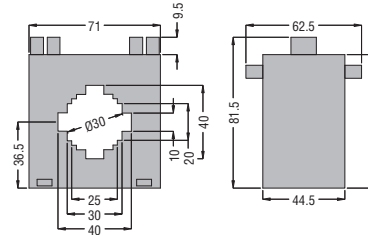

#### DM4T...

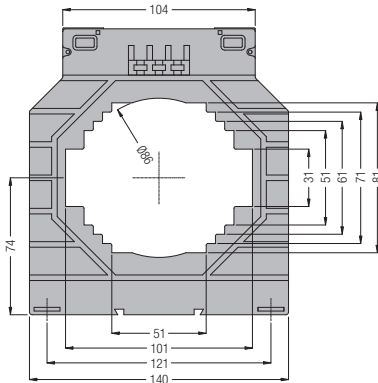

#### DM5T...

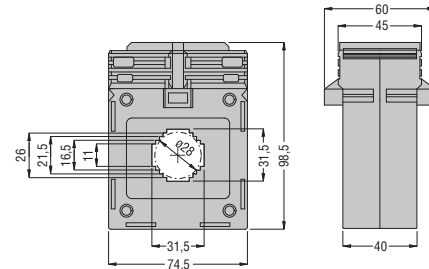

#### Rdzeń otwierany DM1TA...

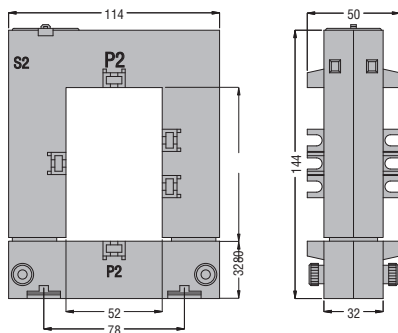

#### DM2TA...

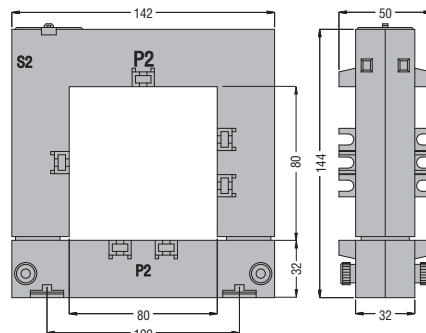

#### DM3TA...

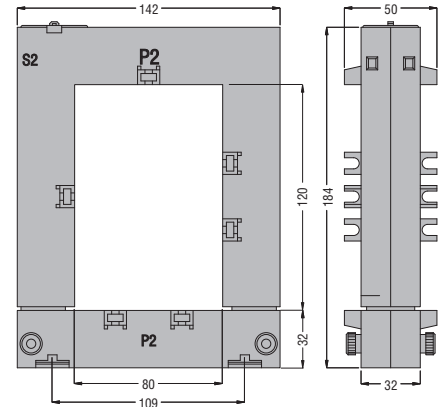

#### DM4TA...

